



LONGBOARD FIN BOX INSTALLATION GUIDE



STEP 1: ROUTE THE CAVITY

OVERVIEW: WHAT YOU'LL NEED

PLUNGE ROUTER

MAKITA RP1800 PICTURED

1/2 INCH (12.7mm) FIBREGLASS BIT

CARBITool T6 16 1/2 E/C

5/8 INCH (16mm) TEMPLATE GUIDE

MAKITA 344364-5 PICTURED

FCS LB ROUTER JIG

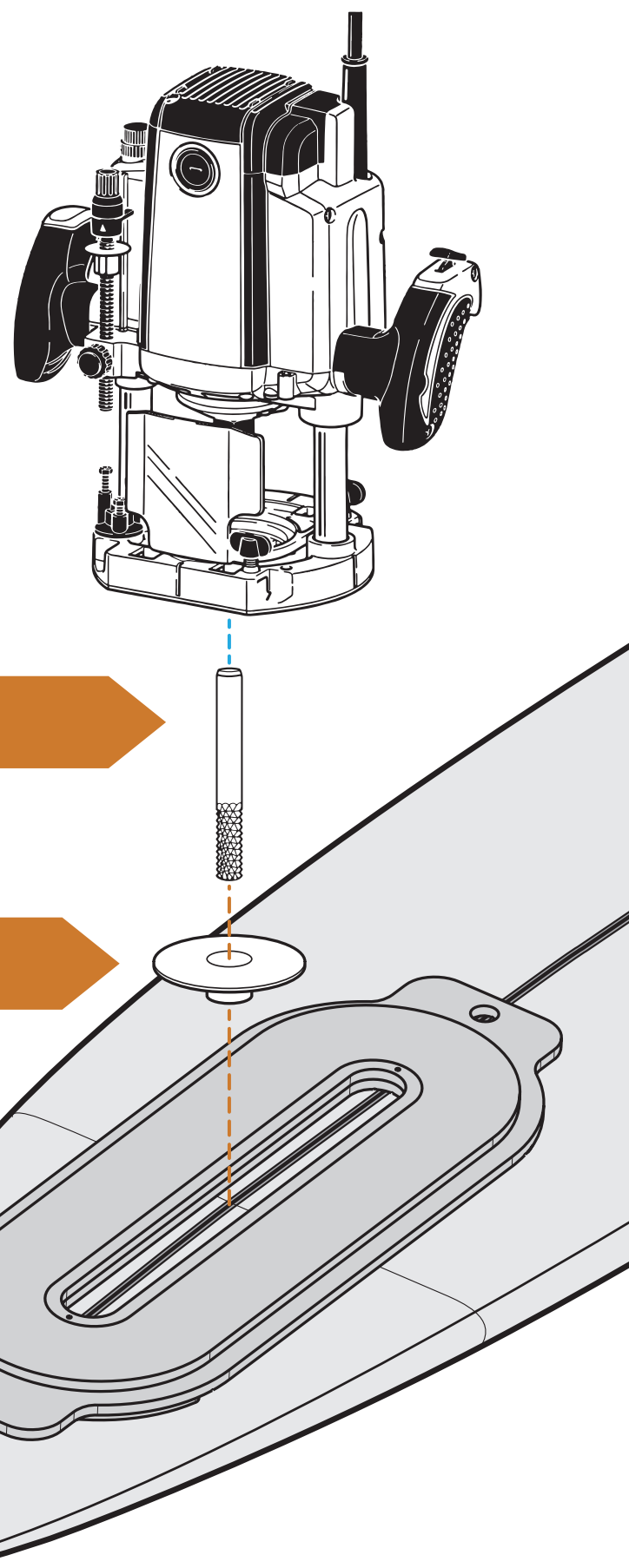

1.1 SET ROUTE DEPTH

- NOTE FULL JIG THICKNESS WHEN SETTING MAX PLUNGE DEPTH.

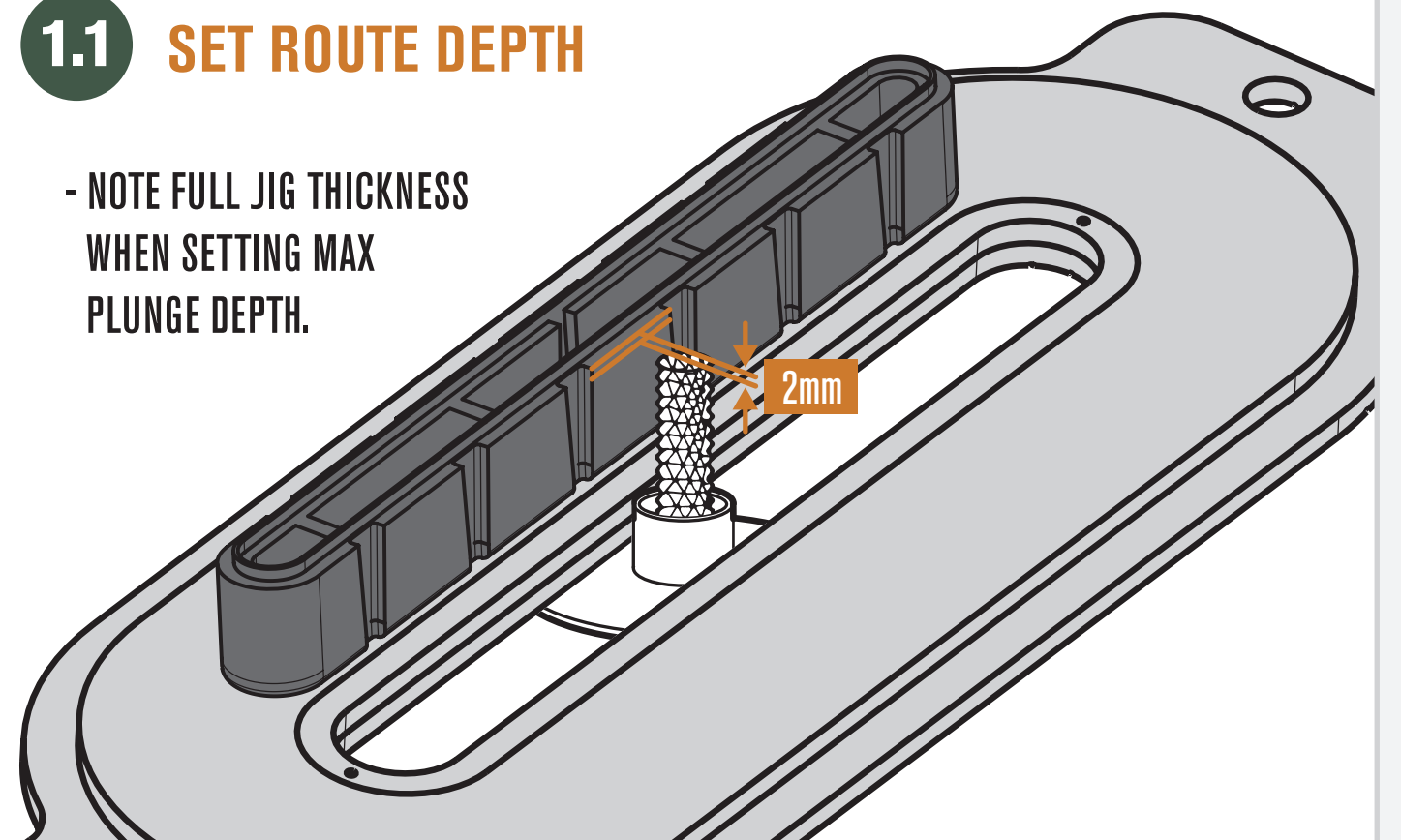

1.2 ROUTE CAVITY

- SECURE JIG WITH TAPE OR CLAMPS.
- COMPLETE ROUTE WITH MIN 2 DEPTH PASSES.

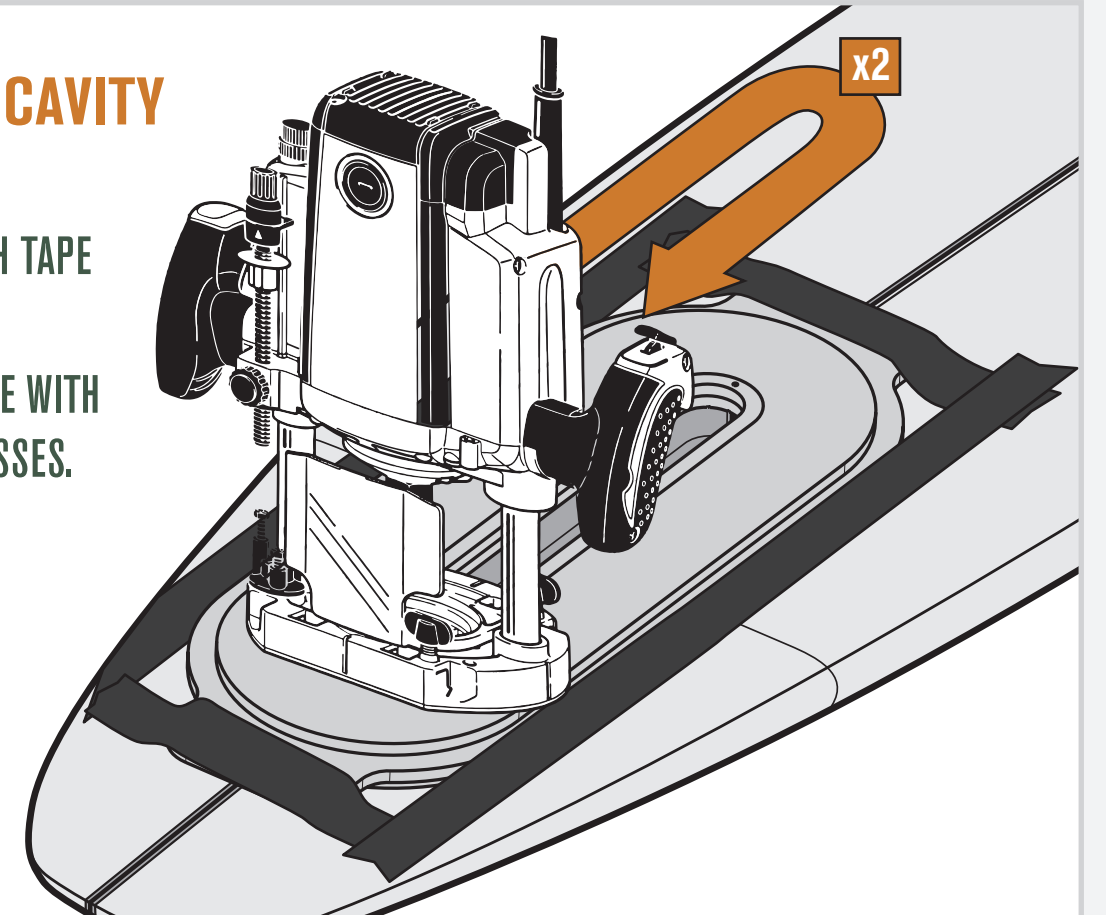

STEP 2: INSTALLING THE BOX

OVERVIEW: WHAT YOU'LL NEED

FCS LB DUMMY JIG

FCS LB FIN BOX

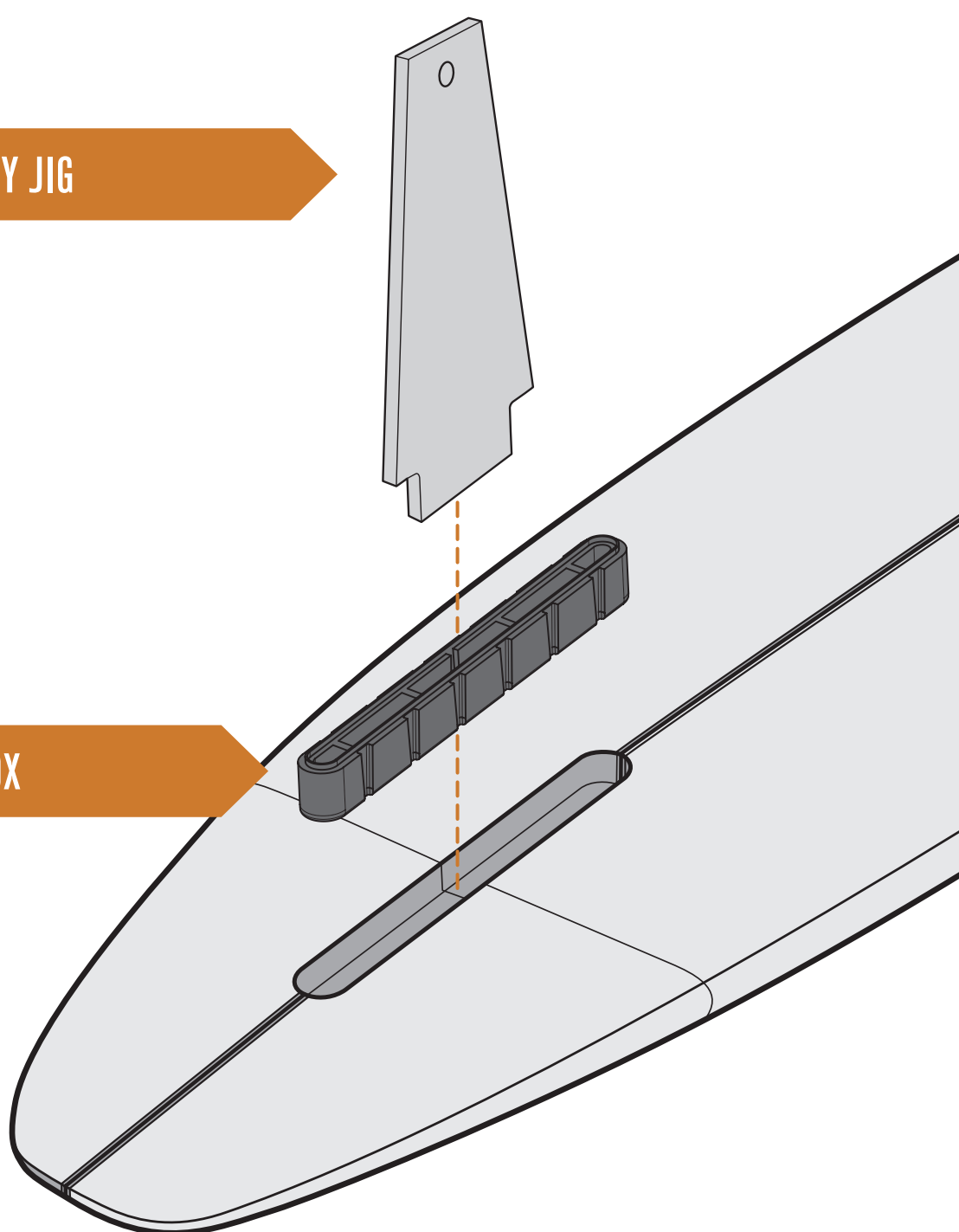

2.1 INSTALL LONGBOARD FIN BOX

- BRUSH LB BOX WITH ACETONE.
- CREATE DAM WITH TAPE.
- ADD FIBREGLASS POWDER & WHITE PIGMENT TO RESIN.
- POUR LAYER OF RESIN IN CAVITY, INSERT BOX AND BACKFILL REMAINING RESIN.

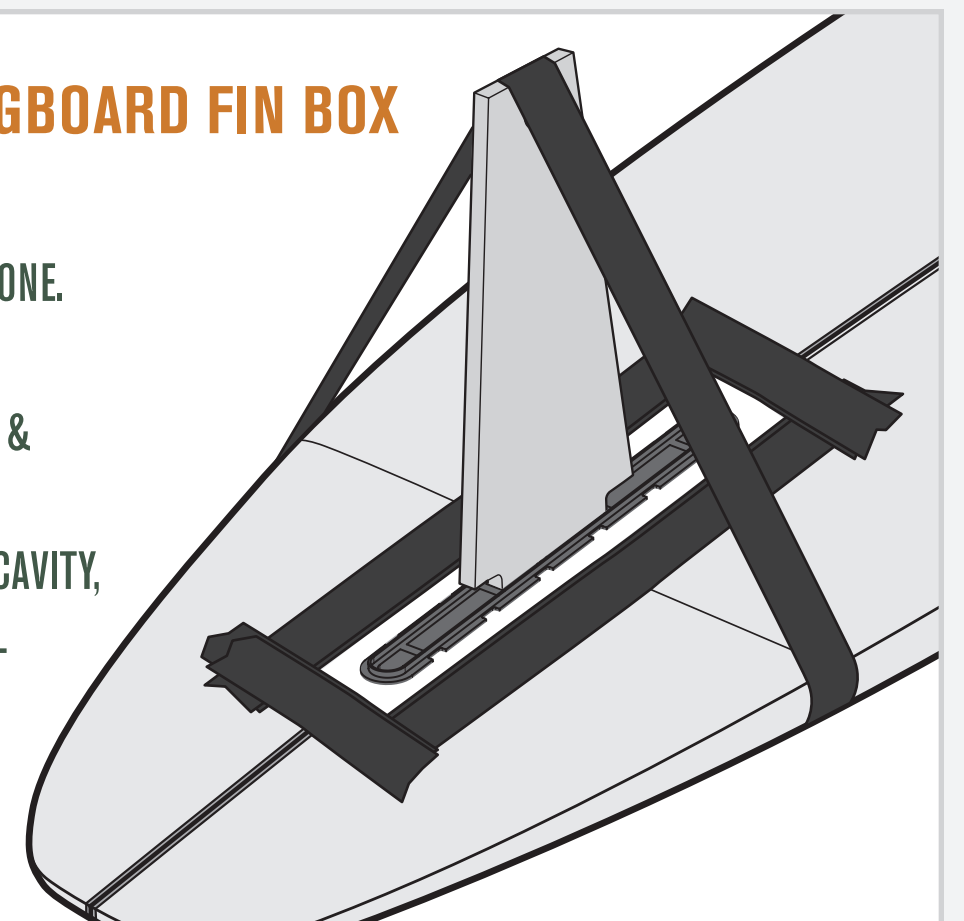

2.2 SAND LONGBOARD FIN BOX

- SAND BOX COMPLETELY FLUSH WITH BOARD.
- SUPPORT RIBS IN SLOT WILL BE REMOVED DURING SANDING.

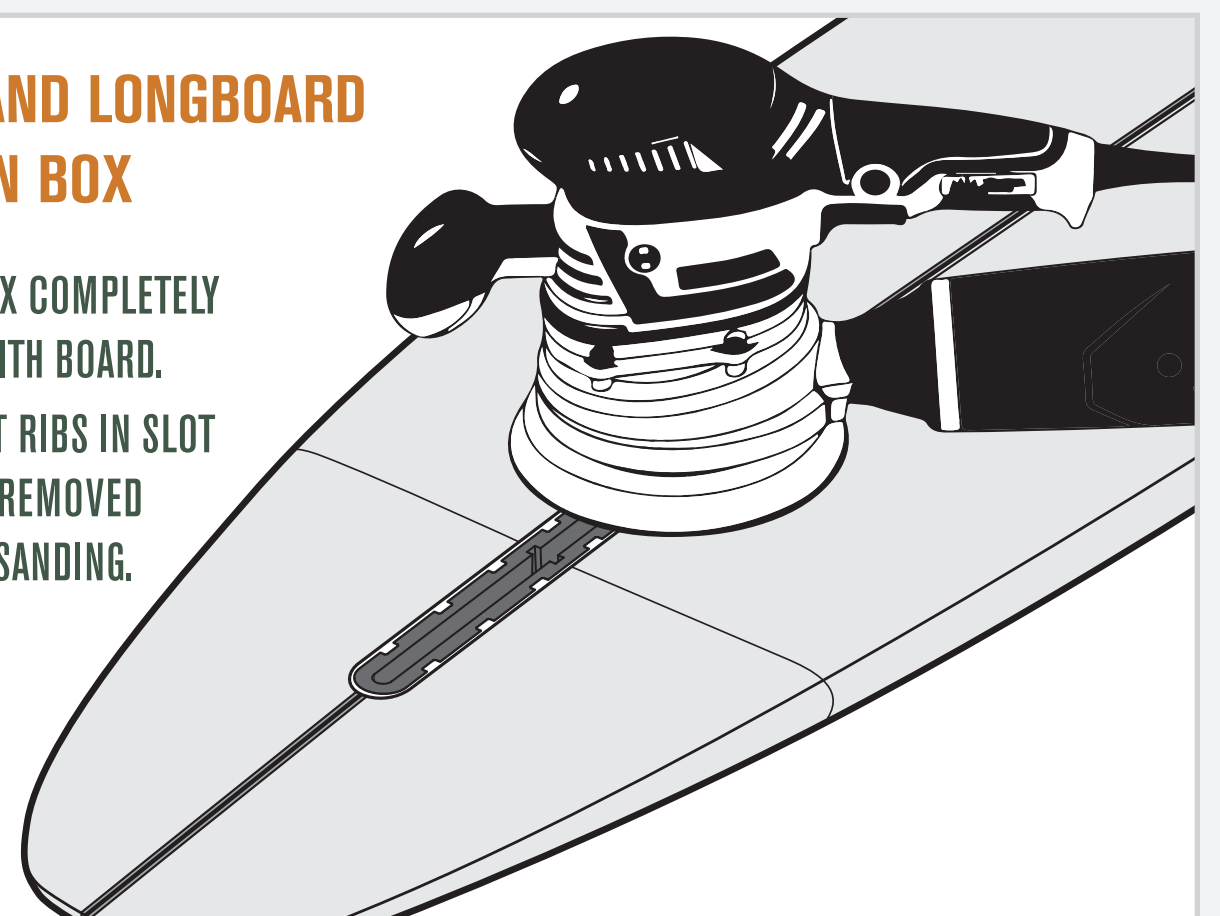

*ALWAYS WEAR PERSONAL PROTECTIVE EQUIPMENT AND ONLY HANDLE TOOLS THAT YOU ARE TRAINED TO USE